

**Wall valve clockwise closing cold 1/2" - Chrome**







CL.1

36 607 716

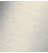

- rosette 60 x 60 mm
- with cold marking
- head part with cut-to-length spindle and sleeve

Fits: CL.1, CYO

	Chrome	36 607 716-00
	Brushed Platinum	36 607 716-06
	Dark Chrome	36 607 716-19
	Brushed Durabronze (23kt Gold)	36 607 716-28
	Brushed Champagne (22kt Gold)	36 607 716-46
	Champagne (22kt Gold)	36 607 716-47
	Brushed Dark Platinum	36 607 716-99

**Required miscellaneous**



**Wall valve 1/2" -** 35 607 970-90  
 •min. recess depth 105 mm 0010  
 •max. recess depth 150 mm

36 607 716

mm [inches]

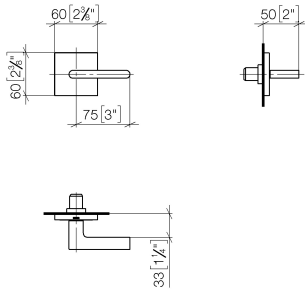

Codes & Standards

ADA	ASME A112.18.1/CSA B125.1
-----	---------------------------------

Certificates

DVGW_DW- 6501DN0116.	IAPMO_4976 (1).	LGA_29931.	WRAS_2010066.	LGA_29932.
-------------------------	-----------------	------------	---------------	------------

36 607 716

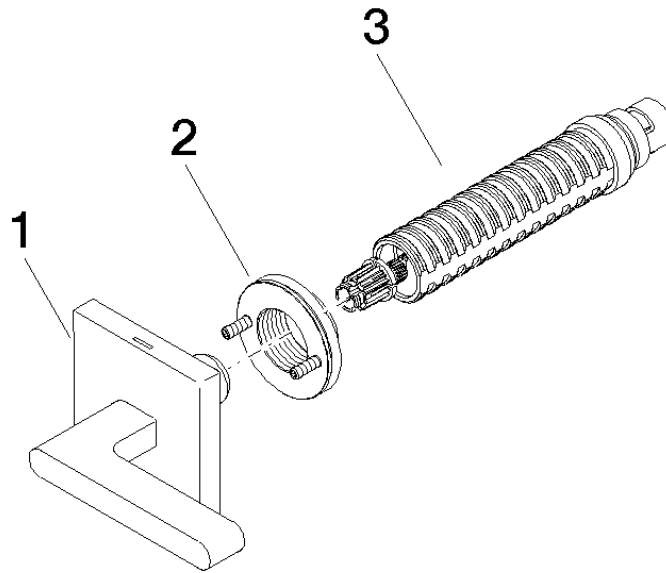

### Spare parts list

No.	Item Number	Name	Quantity used	Delivery time
1	90 20 70 057 04-00	handle ( cold )	1	10
2	90 21 02 108 00 90	disc	1	2
3	90 90 03 143 00 90	top	1	2